



GlobalView™ Mail Reputation Service



Real-Time Perimeter Defense Against Spam and Malware

Leverage the world's most comprehensive email security network by using the GlobalView™ Mail Reputation Service. Commtouch's real-time analysis of a representative sample of global email traffic:

- Identifies hundreds of thousands of new zombies daily
- Tracks traffic from over tens of millions of IP addresses
- Classifies billions of messages per week, in real-time

Achieve unprecedented performance and detection levels, blocking zombie traffic before it ever enters your customers' networks.

GlobalView compiles historical and up-to-the-minute sender reputation data from highly diverse traffic sources in every country, covering the range from managed services and networking hardware devices all the way to desktop software. Patented Recurrent Pattern Detection™ technology automatically aggregates this bird's eye view of all senders, and distinguishes in real-time between legitimate corporate senders, valid publishers, zombies, and spammers/ malware distributors.

"Every enterprise and service provider should seriously consider incorporating a reputation service as part of its spam and virus control strategy. Commtouch's combination of global monitoring together with real time analysis can provide a competitive edge to its licensees."

Richi Jennings, Ferris Research

Anatomy of a Zombie

| | |
|--|--|
| Spam activity on the Internet accounted for by zombies | 85% of global spam, or an estimated 120 billion messages daily |
| New zombies that come 'alive' every 24 hours | 200,000- 500,000 |
| Typical number of messages a botnet sends | Up to 1 billion spam messages in a few hours |
| Typical number of zombies per single botnet | 10,000-200,000 |
| Number of active zombies per day | 5-10 million |



Benefits for Messaging Security Vendors

With Commtouch Reputation Service you will:

- Increase sales opportunities
- Retain customers' loyalty by improving their service
- Improve sales margins
- Reduce overhead and enable higher throughput for security systems

GlobalView™ Mail Reputation Service

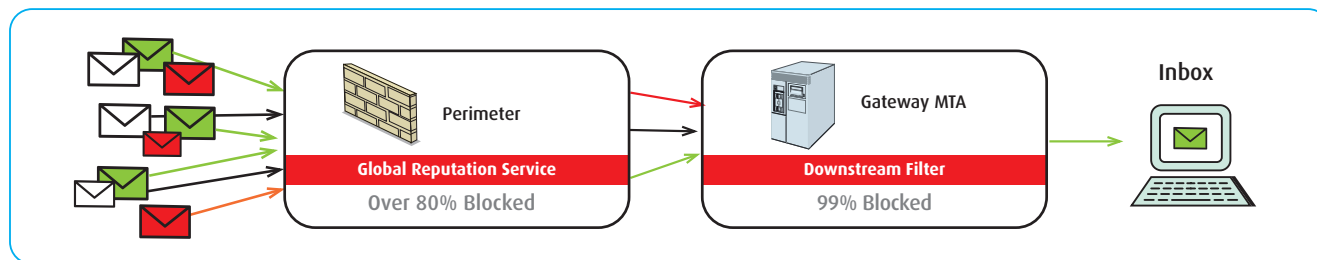

Features

- Removes over 80% of unwanted mail at the perimeter
- Real-time botnet detection (less than a minute from attack onset)
- Highly accurate risk assessment based on real-time GlobalView network
 - Comprised of over 80 vendors' networks
 - Spans over 180 countries
 - Collected from all device types: firewalls, messaging appliances, desktop software, service providers
- Aggregates multiple external attributes: DNS information, geography, dynamic IPs, public RBLs, etc.
- Decision Manager increases zombie protection
 - Dynamic time windows for temp-failing and accepting connections
 - Built-in rate limiting
 - Minimizes False Positives
 - Fully configurable and extensible
- Rich data set provided per IP, including:
 - Recommended action: block, throttle, allow
 - IP class – classification of IP into actionable classes
 - IP Risk level – Likelihood of message being unwanted: 0-100
 - Volume and volume spikes
 - Spam ratio and spam ratio spikes
 - Valid bulk data (e.g. newsletters)

How It Works

- Partner device identifies an incoming SMTP connection request
- The device queries GlobalView for reputation information about the sender's IP address
- Based on results, the connection is accepted, temp-failed, perm-failed, or throttled

Benefits for your Customers

Reduces Necessary System Resources: Reduces second-tier resource requirements, e.g. hardware, network, software

Saves Bandwidth, Enhancing Performance: Bandwidth requirements are substantially reduced, guaranteeing better Quality of Service for the remaining traffic.

Increases Security: Filters majority of email-borne viruses, worms and trojans before they enter the network, increasing overall organizational security.

Eliminates False Positives: Through rate-limits and temporary rejects, a measured response to threats virtually eliminates false positives.

Improves Detection Rate: Overall detection rate is improved

Technical Specifications

- Supports all standard MTAs
- Designed for high-scalability scenarios
- Over 4000 messages/second
- HTTP, UDP, and RBL/RBL+ interfaces available
- Multiple deployment options available:
 - Deploy Commtouch daemon locally for built-in caching and failover (Linux, FreeBSD, Solaris and Windows)
 - Access in the cloud service via UDP – no software installation required
- Supports all standard MTA platforms

Visit us at: www.commtouch.com

Contact us at: bizdev@commtouch.com or Call: (650) 864-2114 (US) or +972-9-8636818 (Int'l)

Copyright © 2007 Commtouch Software Ltd. Recurrent Pattern Detection, RPD, Zero-Hour and GlobalView are trademarks, and Commtouch is a registered trademark, of Commtouch Software Ltd. U.S. Patent No. 6,330,590 is owned by Commtouch

commtouch®
Real Security. In Real Time.